

HOBART

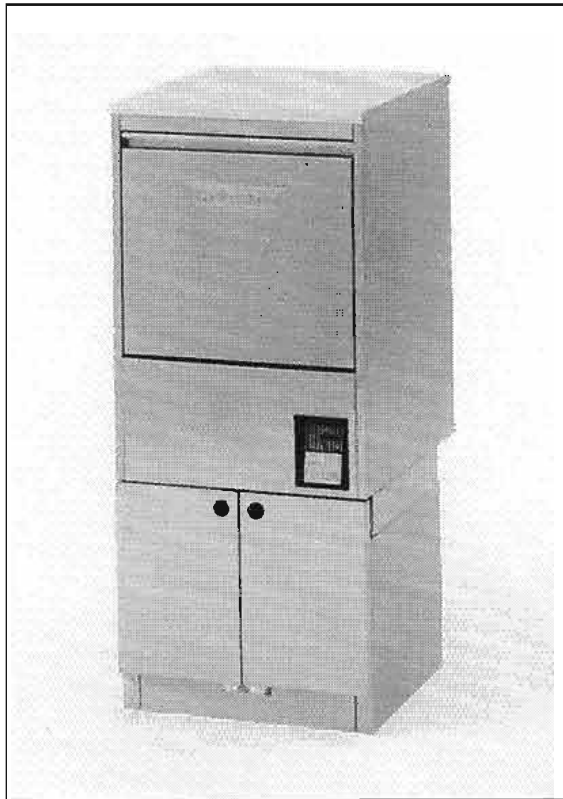

UW-55

Spare Parts
Pièces Détachées
Ersatzteile
Onderdelen

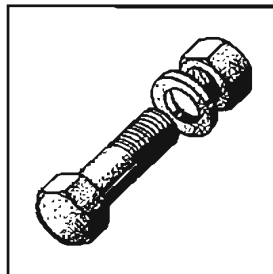

Contents

Tank and panels	3
Door	4
Water inlet	5
Anti-siphon-device	6
Rinse booster heater	7
Wash pump	8
Wash and rinse system	9
Drain and strainers	10
Drain pump	11
Rinse booster pump	12
Control box	13
Transformer	14
Detergent dispenser	15
Rinse agent dispenser	16/17
Extension for 900 mm height	18
Supporting frame	19

Inhalt

Tank und Verkleidungen	3
Tür	4
Eingangsleitung	5
Rücksaugeverhinderer	6
Durchlauferhitzer	7
Waschpumpe	8
Wasch- und Spülsystem	9
Ablauf und Siebe	10
Ablaufpumpe	11
Drucksteigerungspumpe	12
Schaltkasten	13
Transformator	14
Reiniger-Dosiergerät	15
Klarspülmittel-Dosiergerät	16/17
Sockel für 900 mm Höhe	18
Untergestell	19

Sommaire

Bac et panneaux	3
Porte	4
Arrivée d'eau	5
Brise-vide	6
Chaudière	7
Pompe de lavage	8
Système de lavage et de rinçage	9
Vidange et filtres	10
Pompe de vidange	11
Pompe élévatrice de pression	12
Coffret électrique	13
Transformateur	14
Doseur de produit détergent	15
Doseur de produit lessiviel	16/17
Socle pour 900 mm hauteur	18
Bâti inférieur	19

Inhoud

Tank en panelen	3
Deur	4
Water toevoer	5
Vacuumbreker	6
Booster	7
Waspomp	8
Was en spoelsysteem	9
Afvoer en zeven	10
Afvoerpomp	11
Spoelpomp	12
Schakelkast	13
Transformator	14
Wasmiddel-doseerapparaat	15
Spoelmiddel-doseerapparaat	16/17
Uitbreiding voor 900 mm hoogte	18
Onderstel	19

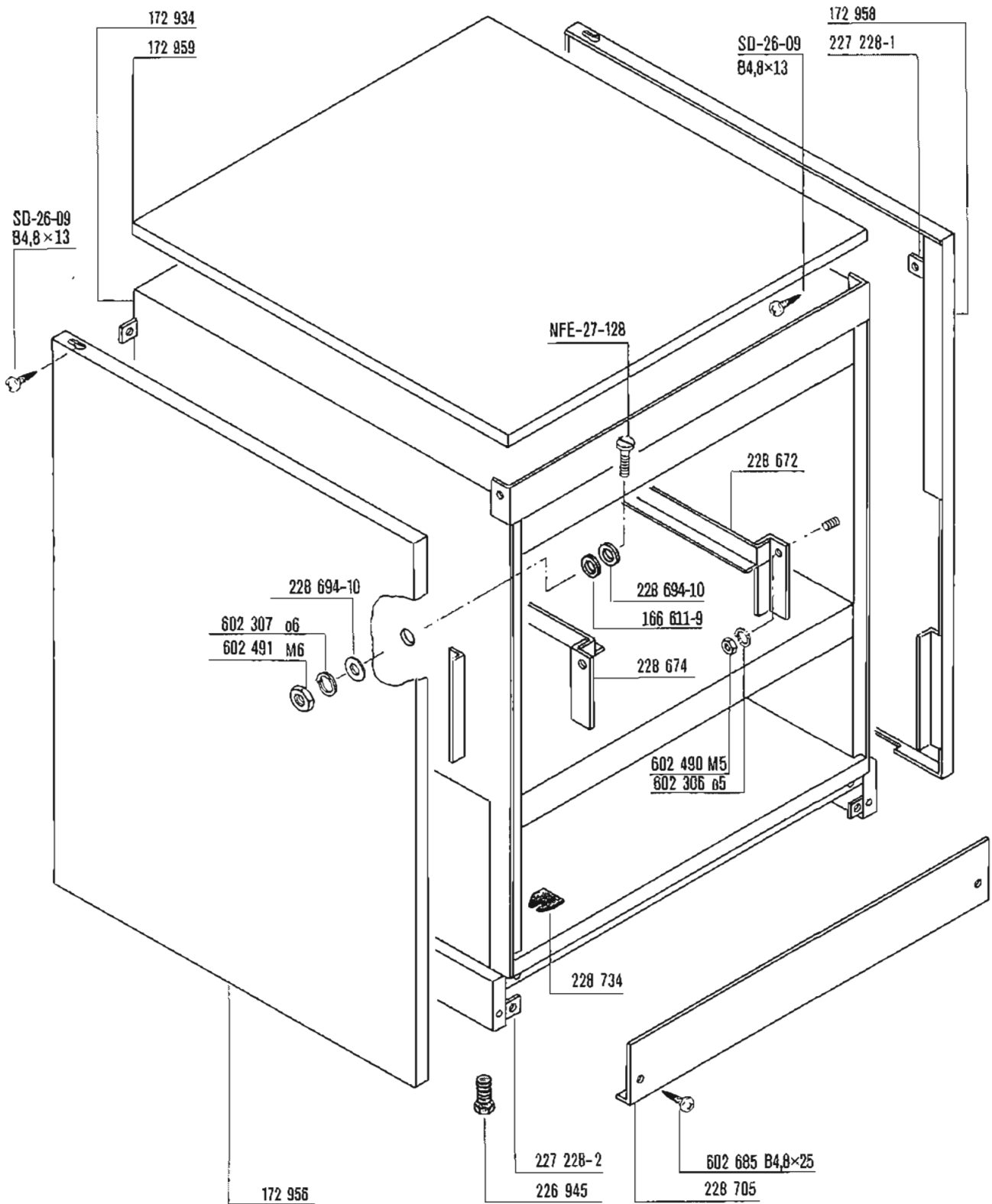

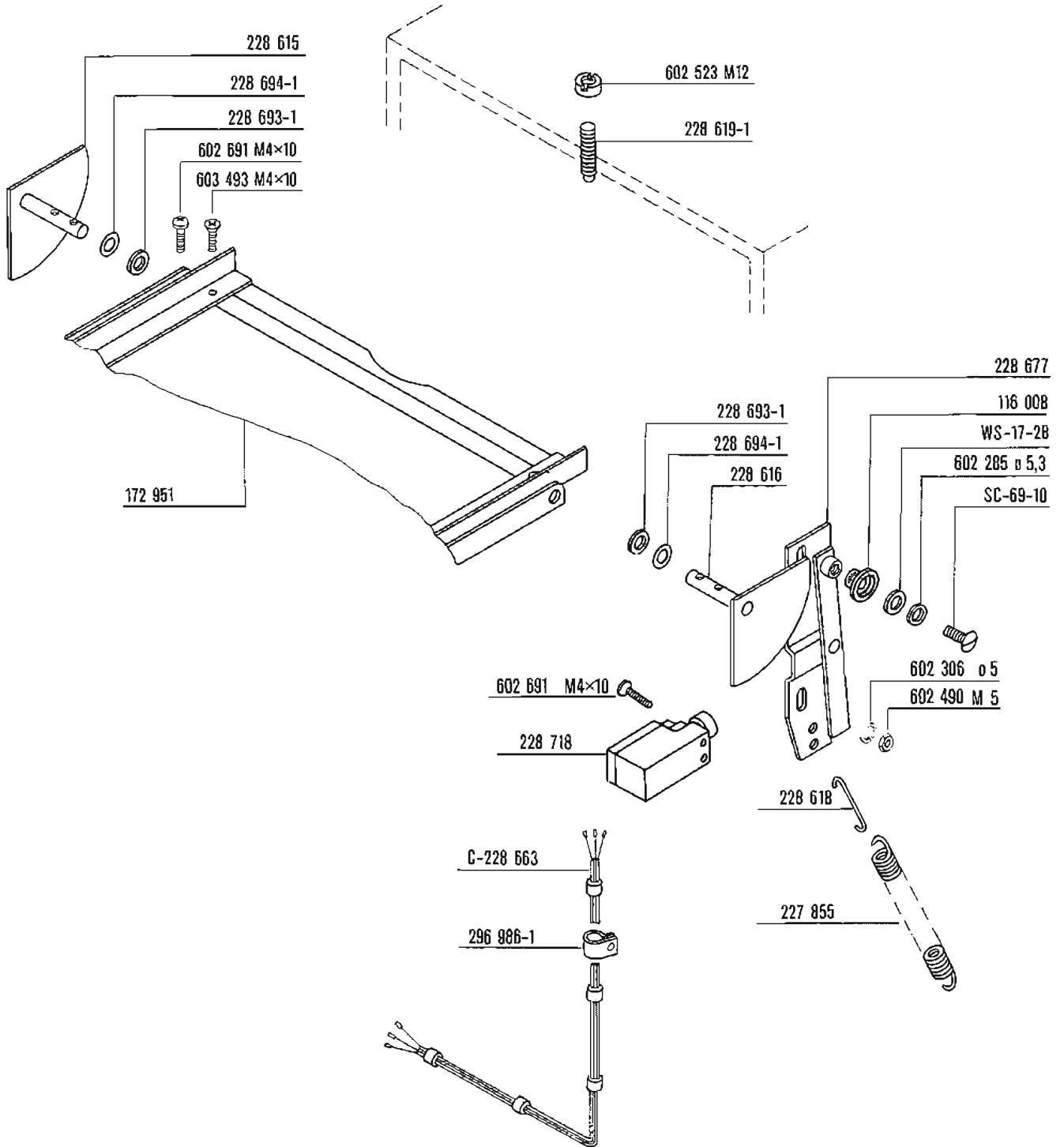

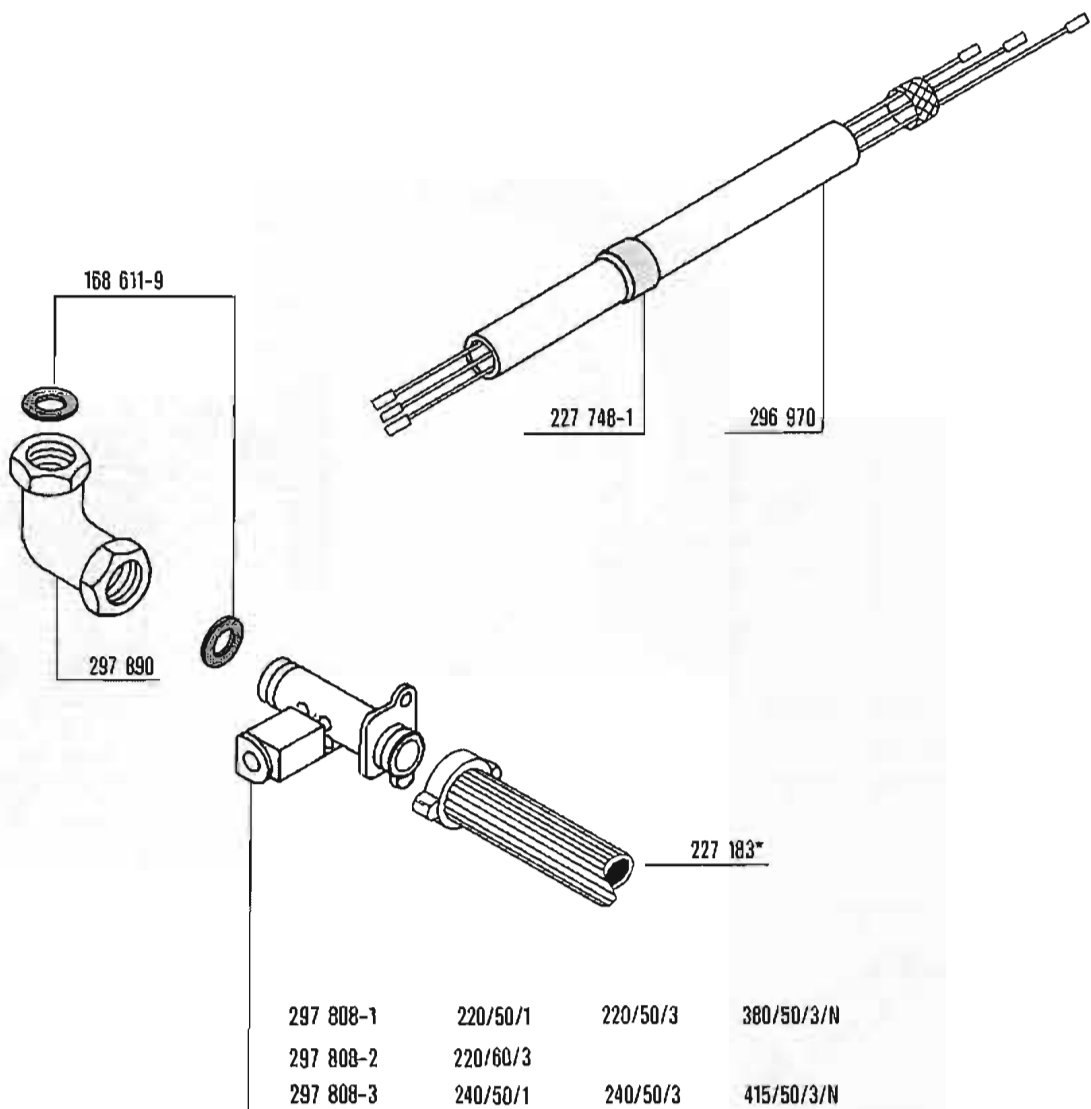

*with drain pump only
 sft. avec pompe de vidange
 nur bei Ablaufpumpe
 alleen met afvoerpomp

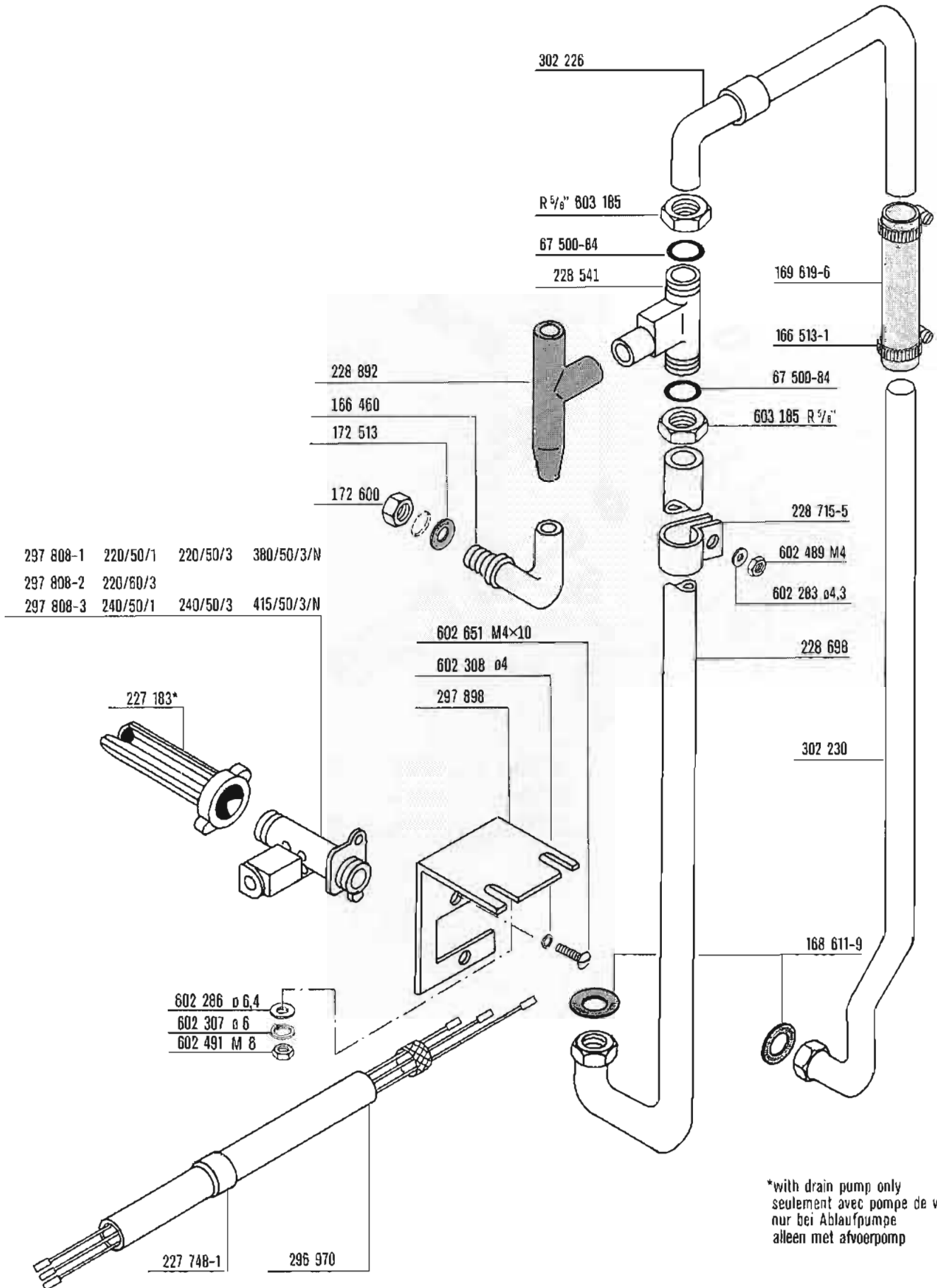

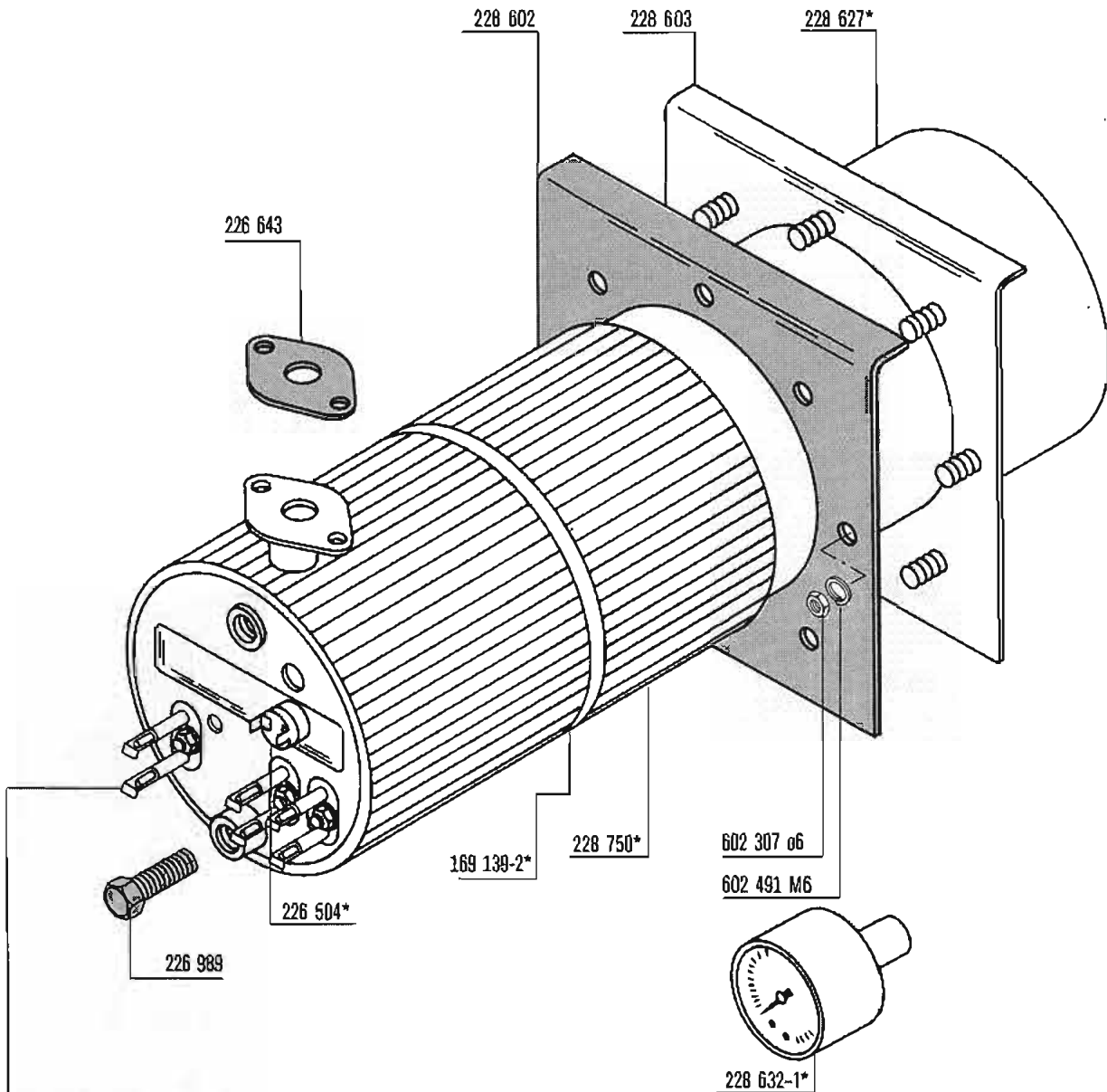

228 579-1*	2,5 kW	380/50/3 380/50/3/N
228 579-2*	2,5 kW	415/50/3 415/50/3/N
228 579-3*	2,5 kW	440/60/3
227 953-1*	2 kW	220/50/3 220/60/3 380/50/3 380/50/3/N
227 953-2*	2 kW	240/50/3 415/50/3 415/50/3/N
227 953-3*	2 kW	440/60/3
165 099-1*	1,5 kW	220/50/1 220/50/3 220/60/3 380/50/3 380/50/3/N
165 099-2*	1,5 kW	240/50/1 240/50/3 415/50/3 415/50/3/N
165 099-3*	1,5 kW	415/50/3/N 440/60/3

assembly incl.*	228 626-3	7,5 kW	380/50/3 380/50/3/N
ensemble compr.*	228 626-4	7,5kW	415/50/3 415/50/3/N
komplett inkl.*	228 626-6	7,5 kW	440/60/3
	228 626-7	6 kW	220/50/3 220/60/3 380/50/3 380/50/3/N
	228 626-8	6 kW	240/50/3 415/50/3 415/50/3/N
	228 626-9	6 kW	440/60/3
	228 626-1	4,5 kW	220/50/1 220/50/3 220/60/3 380/50/3 380/50/3/N
	228 626-2	4,5 kW	240/50/1 240/50/3 415/50/3 415/50/3/N
	228 626-5	4,5 kW	440/60/3

172 981-1	220-380/50/3-N
172 981-2	240-415/50/3-N
172 981-6	220/60/3
172 981-5	440/60/3

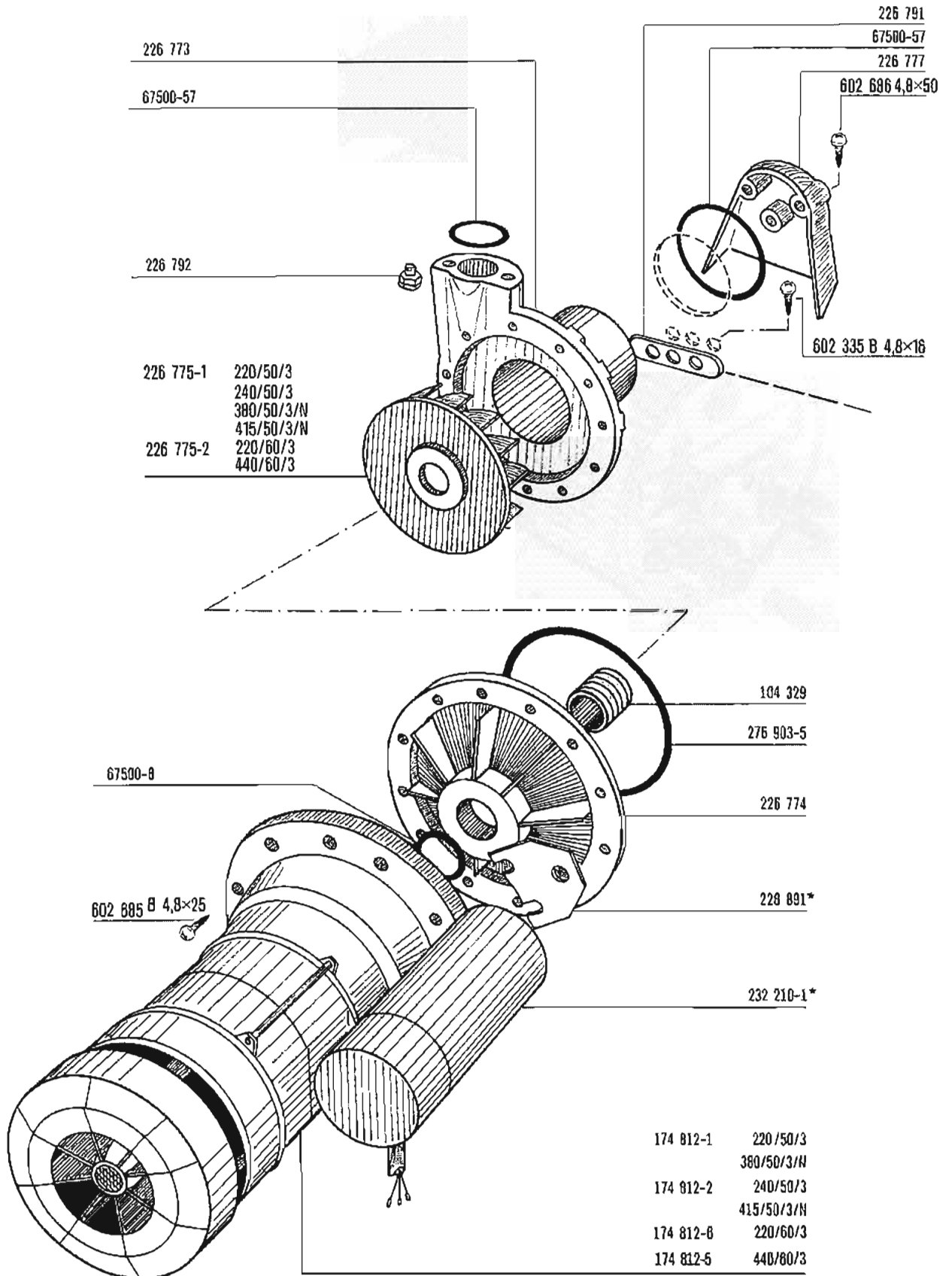

*only / seulement / nur / alleen 220-240/50/1

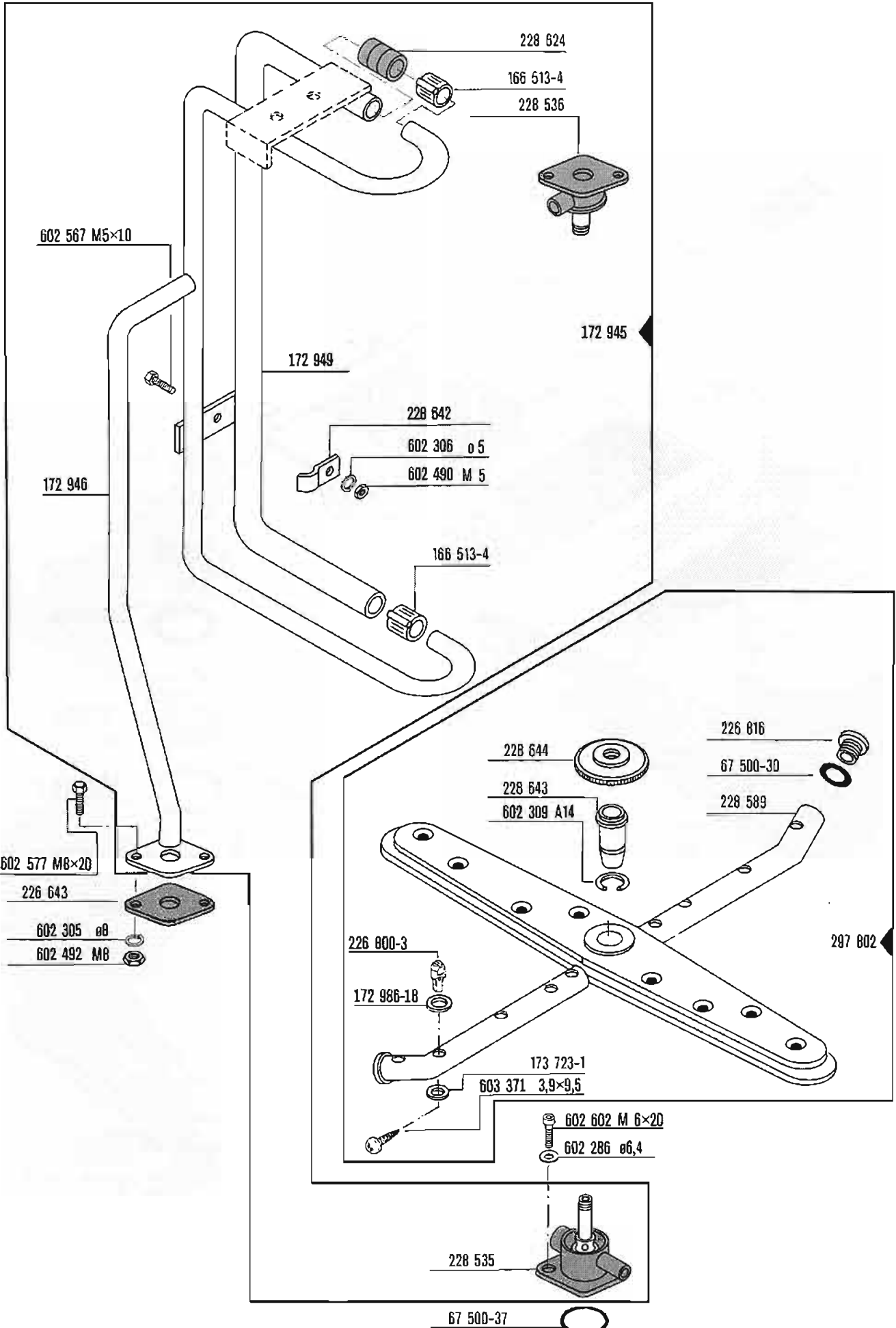

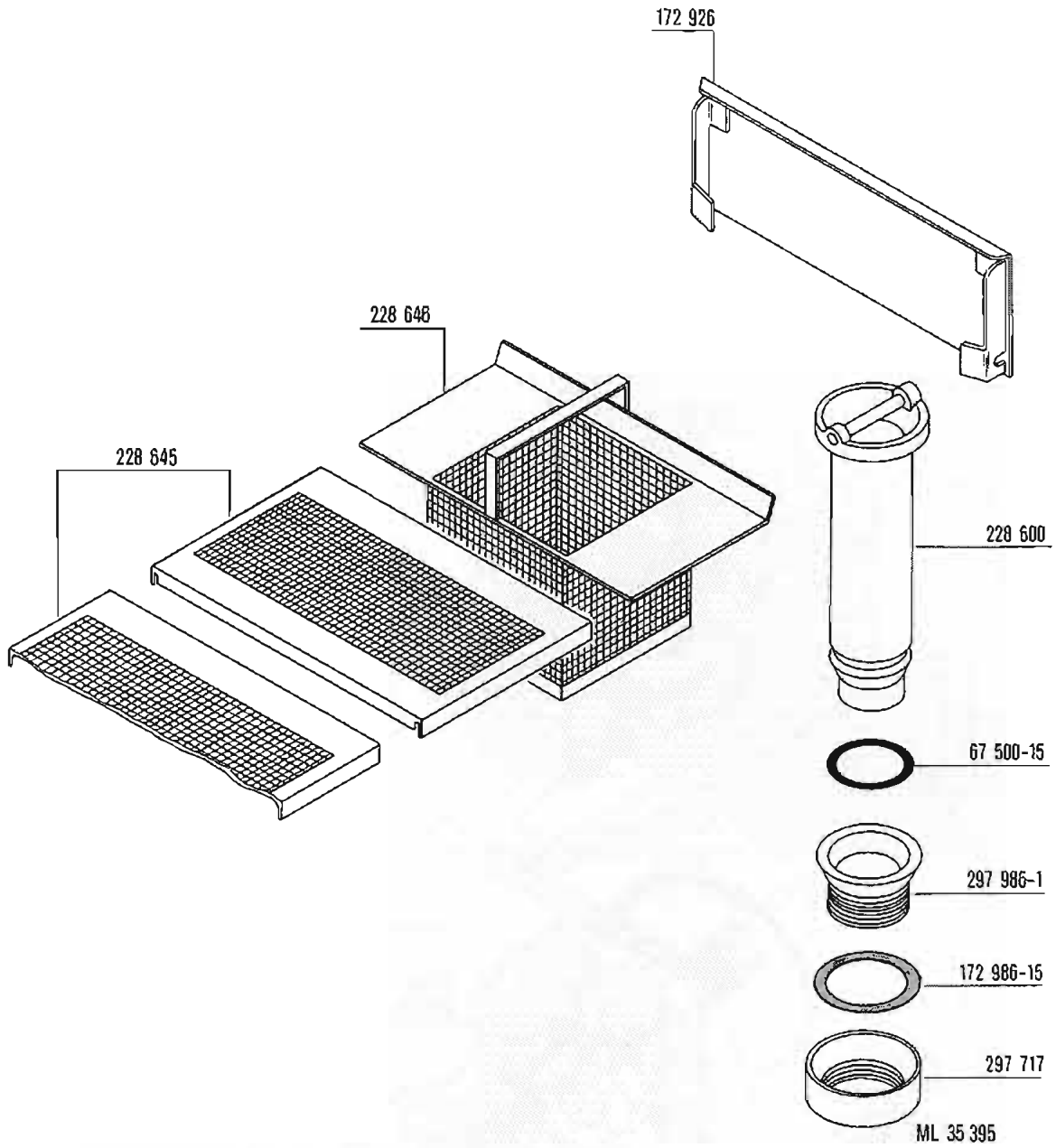

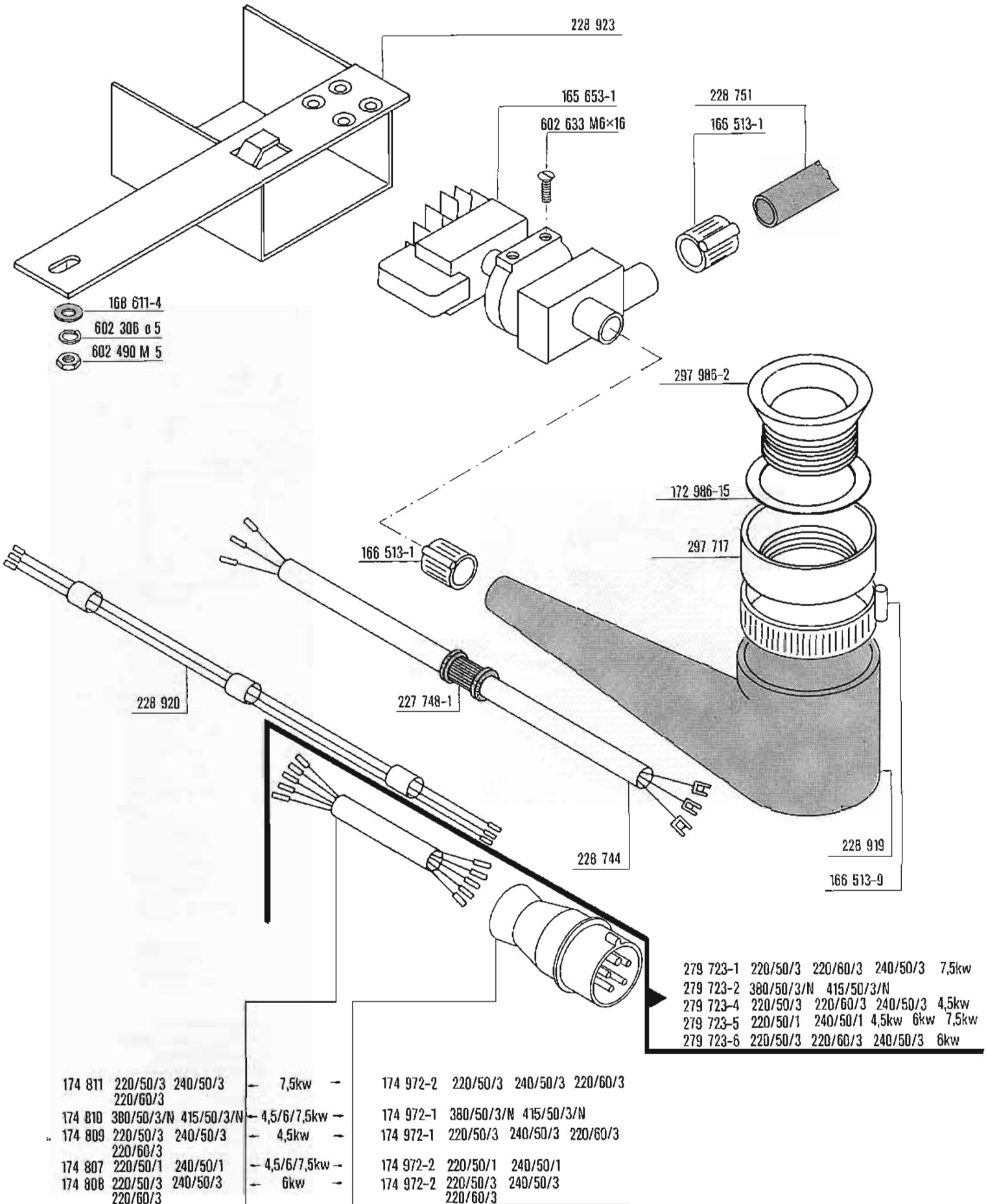

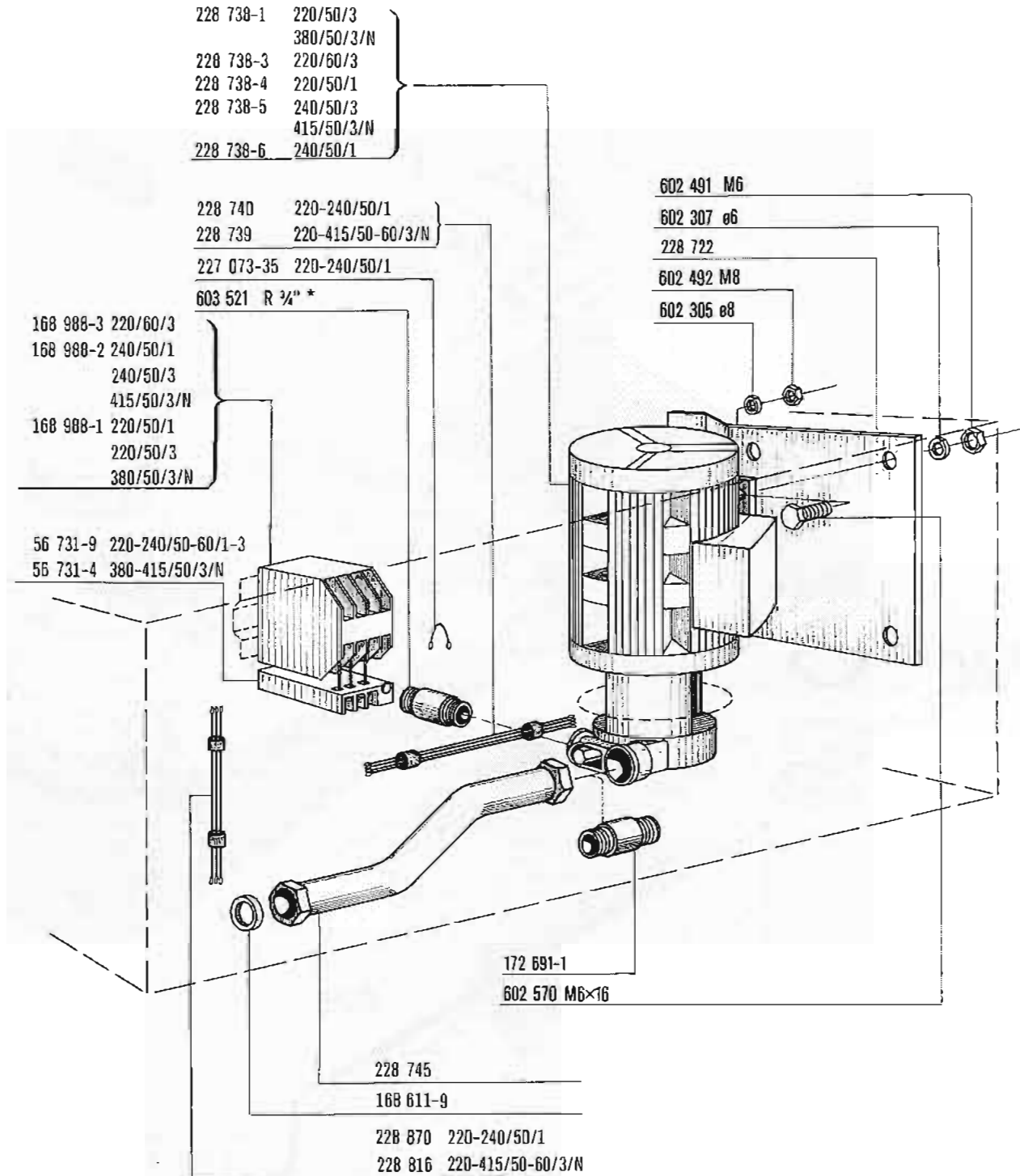

* with drain pump only
 slt. avec pompe de vidange
 nur bei Ablaufpumpe
 alleen met afvoer pomp

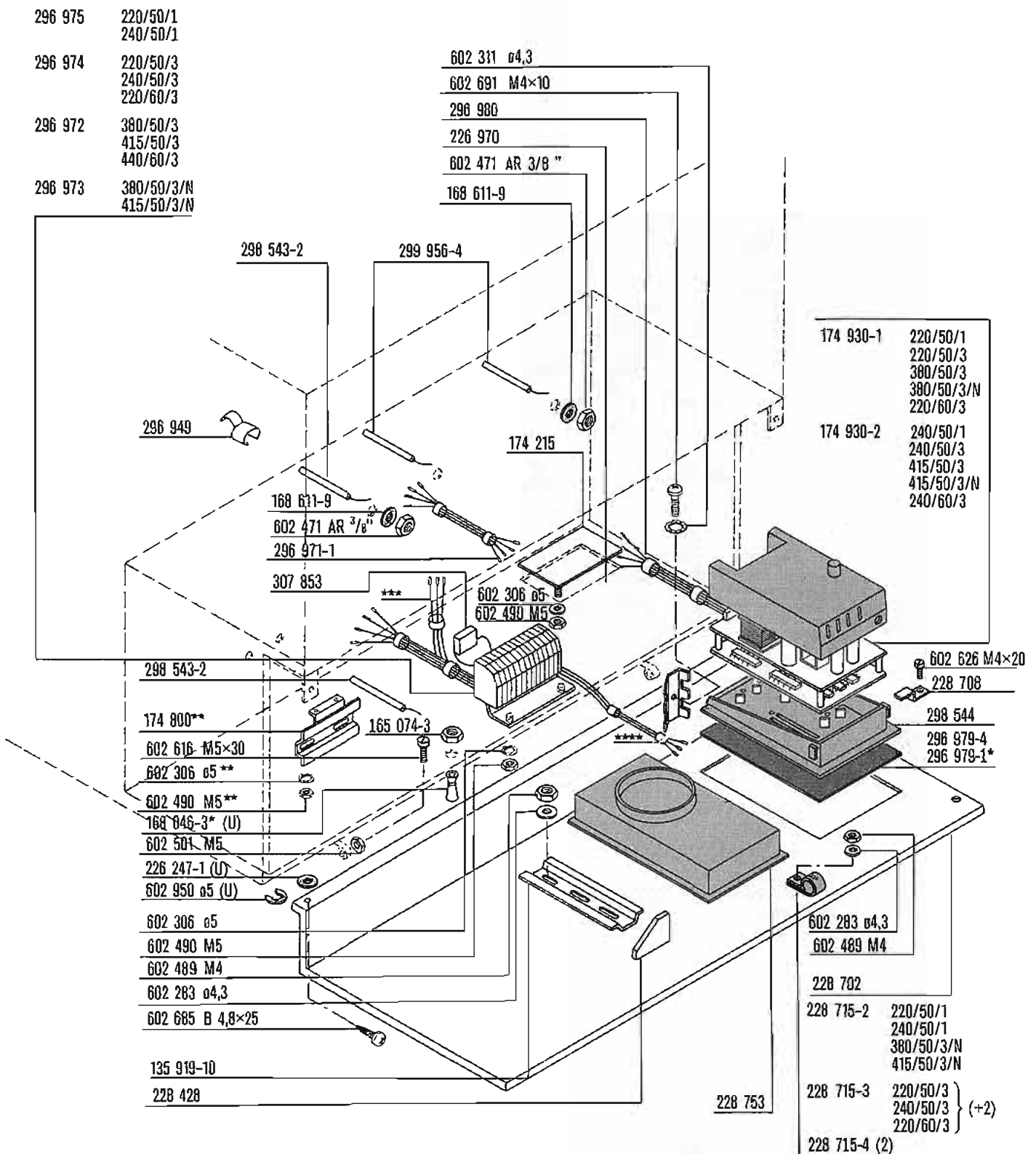

*** 296 984 220/50/3
240/50/3
220/60/3

296 985 220/50/1
240/50/1

296 982 380/50/3
380/50/3/N
415/50/3
415/50/3/N
440/60/3

**** 296 976 220/50/3
240/50/3
380/50/3
415/50/3
380/50/3/N
415/50/3/N

296 977 220/50/1
240/50/1

* with drain pump only
slit. avec pompe de vidange
nur mit Ablaufpumpe
alleen met afvoerpomp

** with rinse pump or detergent dispenser only
slit. avec pompe de rinçage ou doseur détergent
nur bei Drucksteigerungspumpe
oder Waschmittel-Dosiergerät
alleen met spoelpomp of afwasmiddel
doseerapparaat

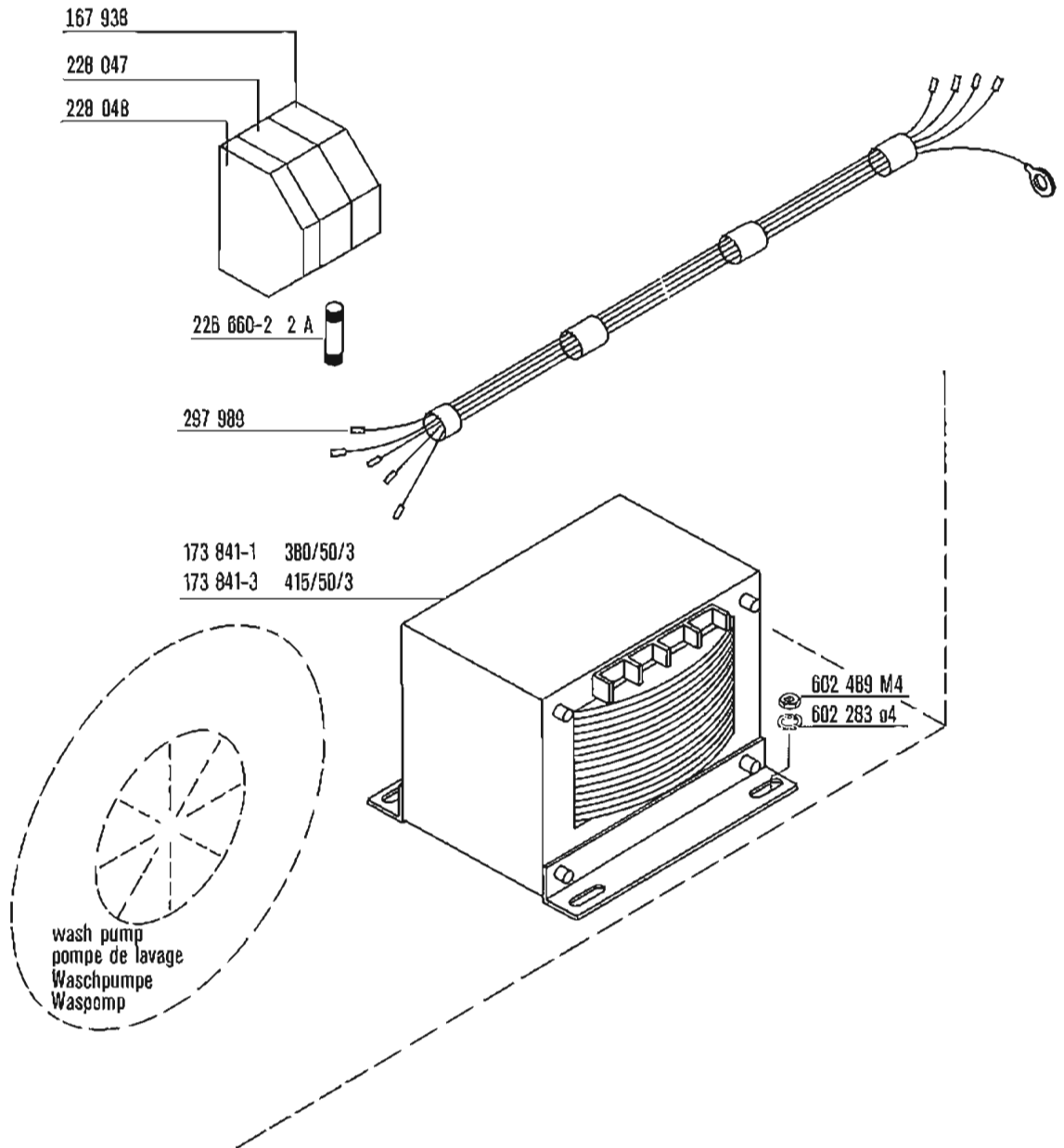

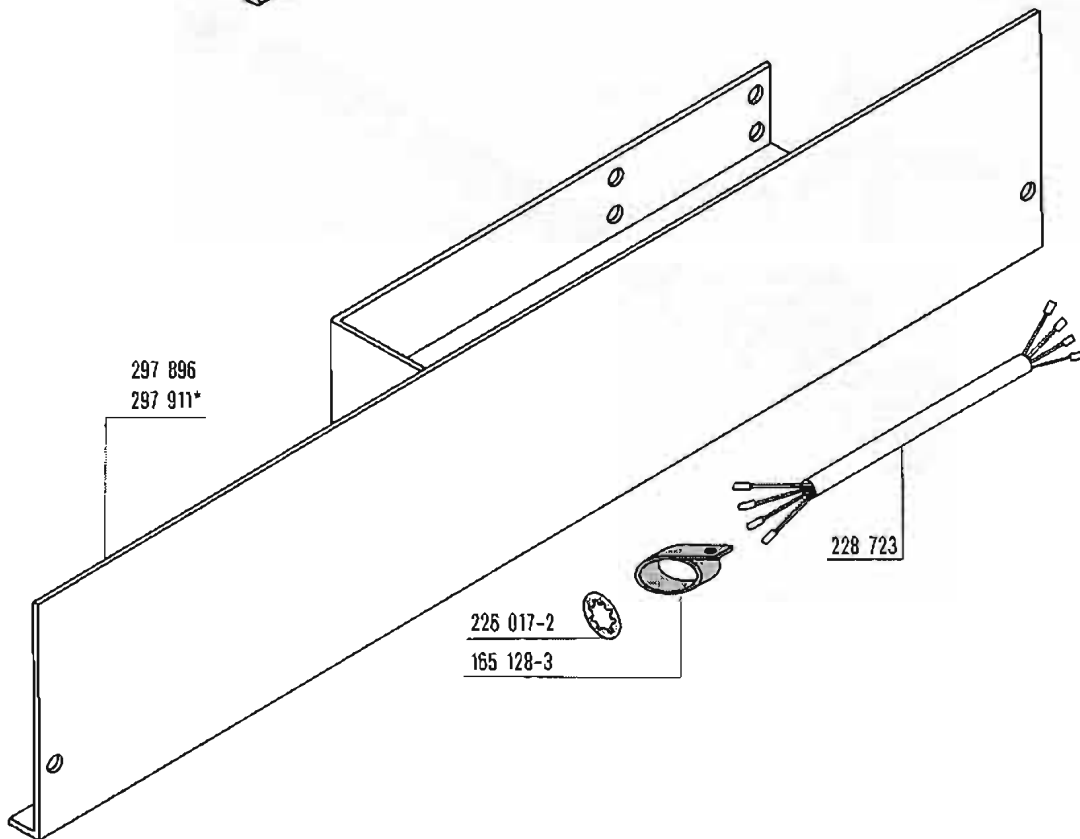
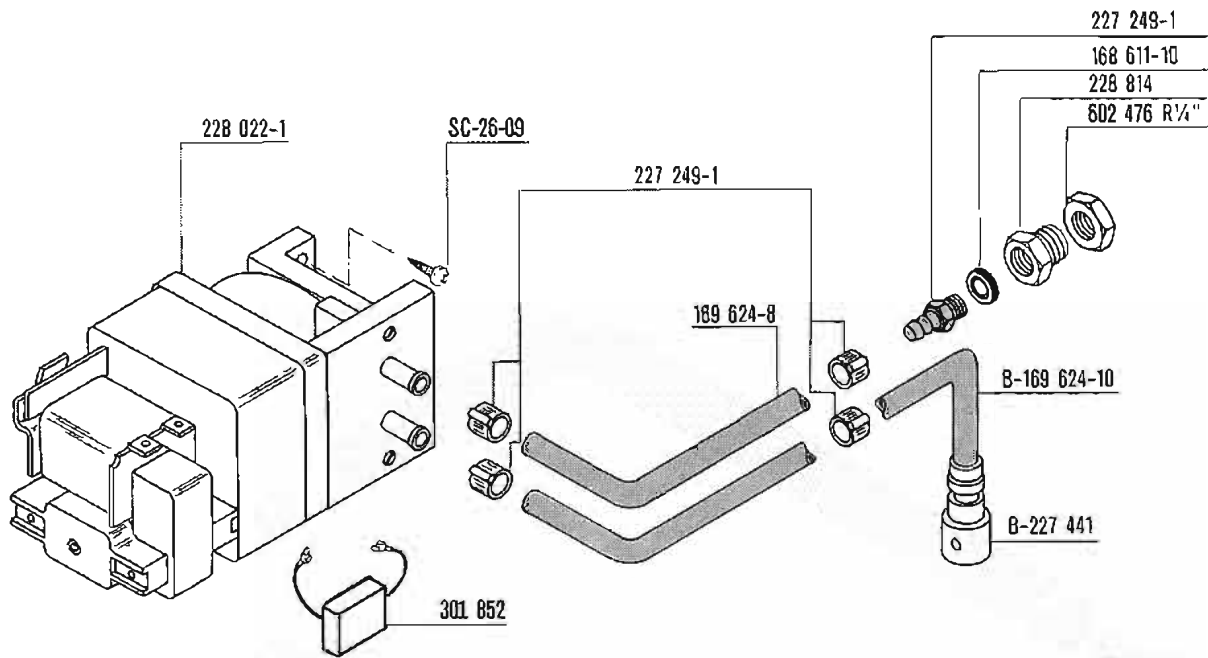

*900 mm machine height
 900 mm hauteur de la machine
 900 mm Maschinenhöhe
 900 mm hoogte

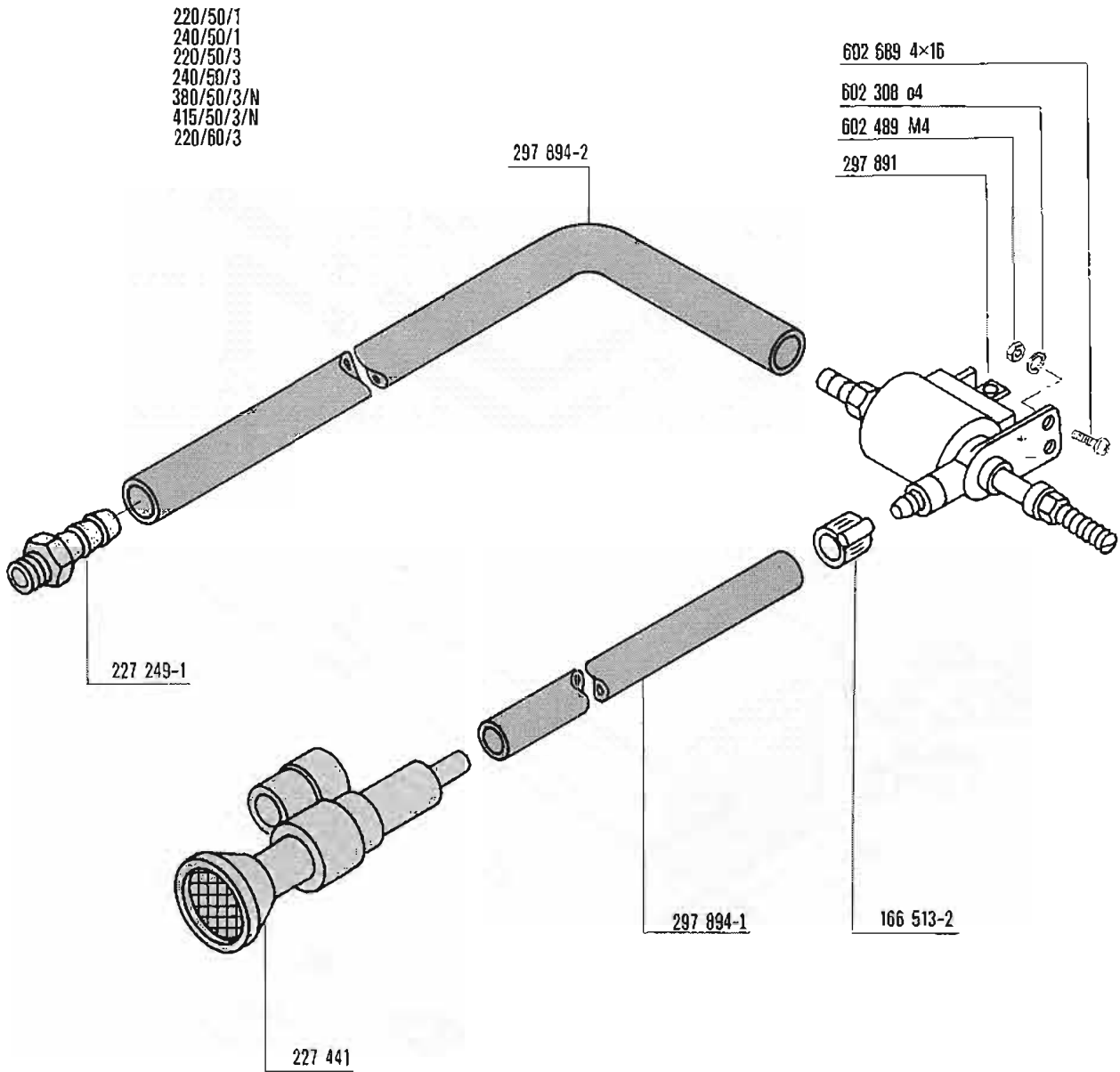

380/50/3 only
415/50/3 stt.
440/60/3 nur
alleen

